

To Let

Office Suite

Roxburgh House
2 Roxburgh Street
Galashiels
TD1 1PF



Units from
174 sq m
(1,874 sq ft) to
359.71 sq m
(3,873 sq ft)

Property Details

- 296 sq m (3,186 sq ft)
- Prominent position
- Attractive period features
- 2 dedicated car spaces with more available by negotiation
- Units from 174 sq m (1,874 sq ft) to 359.71 sq m (3,873 sq ft)

LOCATION:

Galashiels is situated off the A7 amidst the picturesque Borders countryside and lies approximately 18 miles from Peebles, 40 miles south of Edinburgh and 58 miles north of Carlisle. The Scottish Borders Railway provides easy connectivity to Edinburgh and beyond via the station at Tweedbank.

The town is located in the centre of the Scottish Borders and is the principal commercial and administrative hub for the area.

Roxburgh Street lies adjacent to Island Street, one of the main arterial routes through the town. The office is prominently positioned at 1st floor level with visibility to passing traffic and pedestrians.

Nearby occupiers include Triage Central Ltd, Morrison & Murray Engineering Ltd and NHS Borders.

DESCRIPTION:

The subjects comprise the entire ground and first floor accommodation within a prominently positioned standalone office building benefitting from the following:

- Cellular layout with large rooms and high ceilings
- Attractive period features
- Kitchenette
- Male & female toilet facilities
- Power and data points
- Gas fired central heating
- 2 allocated parking spaces with more available by negotiation



Property Details

ACCOMMODATION:

Floor	Accommodation	sq m	sq ft
Ground	Office/ Conference room/ Kitchenette	174.00	1,874
First	Office	185.71	1,999
TOTAL		359.71	3,873

RATEABLE VALUE:

It is understood that the subjects will be required to be reassessed upon entry. Further information on rates payments can be found at www.saa.gov.uk

LEASE TERMS:

The premises are available for let in whole or in part. Our client is seeking offers over £47,500 per annum for the lease of the ground and first floors combined. Please contact the listing agents for quoting rents of individual units.

EPC:

A copy of the EPC for the property can be made available on request.

VAT:

All figures in these particulars are quoted exclusive of VAT.

ENTRY:

By agreement.

LEGAL COSTS:

Each party will be responsible for the payment of their own legal costs involved in any transaction. The incoming tenant will be responsible for the payment of any Land and Buildings Transaction Tax and VAT incurred.

FURTHER INFORMATION:

Strictly by contacting the sole letting agents:

DM HALL



Regulated by
RICS

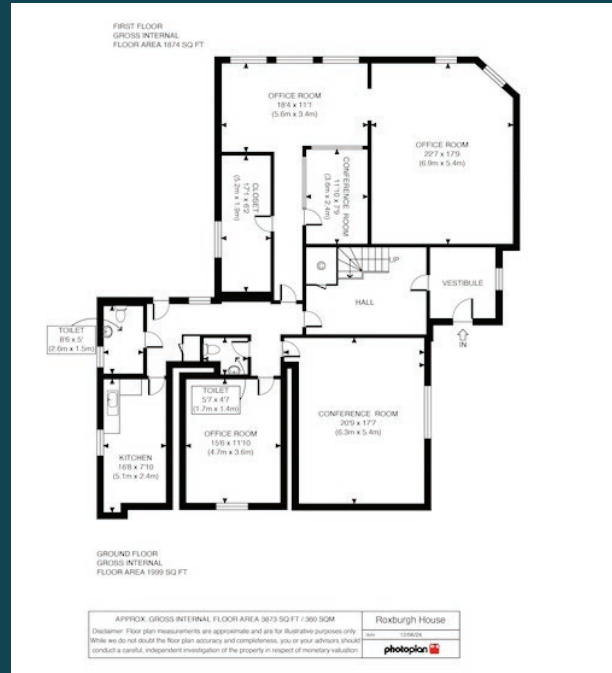

Make an enquiry

Harry Pattullo MSc
Harry.pattullo@dmhall.co.uk

Ian Davidson
ian.davidson@dmhall.co.uk

DM Hall Commercial
17 Corstorphine Road, Murrayburn House
Edinburgh, EH12 6DD
0131 624 6130

IMPORTANT NOTE: DM Hall for themselves and for the vendors or lessors of this property, whose agents they are, give notice that: (i) The particulars are set out as a general outline only for the guidance of intended purchasers or lessees and do not constitute part of, an offer or contract. (ii) All descriptions, dimensions, reference to condition and necessary permissions for use and occupation, and other details are given without responsibility and any intended purchasers or tenants should not rely on them as statement or representation of fact but must satisfy themselves by inspection or otherwise as to the correctness of each of them (iii) No person in the employment of DM Hall has any authority to make or give any representation or warranty whatever in relation to the property. (iv) All prices, premiums and rents quoted are exclusive of VAT. (v) The information contained in these particulars has been checked and, unless otherwise stated, it is understood to be materially correct at the date of publication. After these details have been printed, circumstances may change outside our control (vi) These particulars are provided for record purposes only and are not intended to create, nor to be relied upon as creating, any contractual relationship or commitment. Any contract shall only be entered into by way of our clients' solicitors.