



FOR SALE

INDUSTRIAL

Unit 2, Scalasaig, Isle of Colonsay

Located near the main ferry port of Colonsay.

100% Rates Relief subject to occupier status.

Gross Internal Area of 80.55 sq.m. (867sq.ft.)

Offers over £100,000 are invited.

LOCATION

The subjects are located in Scalasaig, the main settlement and ferry port on the island of Colonsay. Scalasaig is a popular tourist destination on the island, anyone visiting the island will pass through the main ferry terminal.

Colonsay is an island of approximately 40km circumference, famous for being the world's smallest island to have two independent distilleries producing award-winning gins.

The island is accessible from the port of Oban which is approximately 2 hours' drive from Glasgow and 3 hours from Edinburgh. There is a regular Caledonian MacBrayne car ferry service from Oban to Colonsay which takes 2 hours approximately.

Local business on the island includes oyster farming, fishing, hospitality, retail, publishing and tourism services.

DESCRIPTION

The subjects are located on the ground floor of a single storey building of block construction, surmounted by a pitched tiled roof.

Internally, the property is split into two separate areas including a retail section previously used as a bookstore and a warehouse/workshop area previously used for publishing and distribution. Toilet facilities and a tea prep area are located to the rear.

Access is through a single door entry with large roller shutters to the side. There is large display signage at the rear of the premises visible to the ferry port and local road network.

ACCOMODATION

According to our calculations, the subjects have a total Gross Internal Area of 80.55 sq.m. (867sq.ft.) approximately.

RATES

Rateable Value - £7,500.

Please note that a new occupier has the right to appeal the current assessment.

The subjects benefit from 100% rates relief under the Small Business Bonus Scheme, subject to applicant status.

SALE TERMS

Offers over £100,000 are invited.

VAT

All prices quoted are exclusive of VAT, where applicable.

EPC

A copy of the Energy Performance Certificate is available upon request.

ENTRY

Entry is available upon completion of legal formalities.

LEGAL COSTS

Each party to be responsible for their own legal costs incurred during the transaction.

VIEWING & FURTHER INFORMATION

Strictly by prior arrangement with:-

Claire Hutton

T: 07876 541654

E: Claire.Hutton@dmhall.co.uk

Leah Sellers

T: 07879 626448

E: Leah.Sellers@dmhall.co.uk



DATE OF PUBLICATION
May 2023

REFERENCE
WSA2397

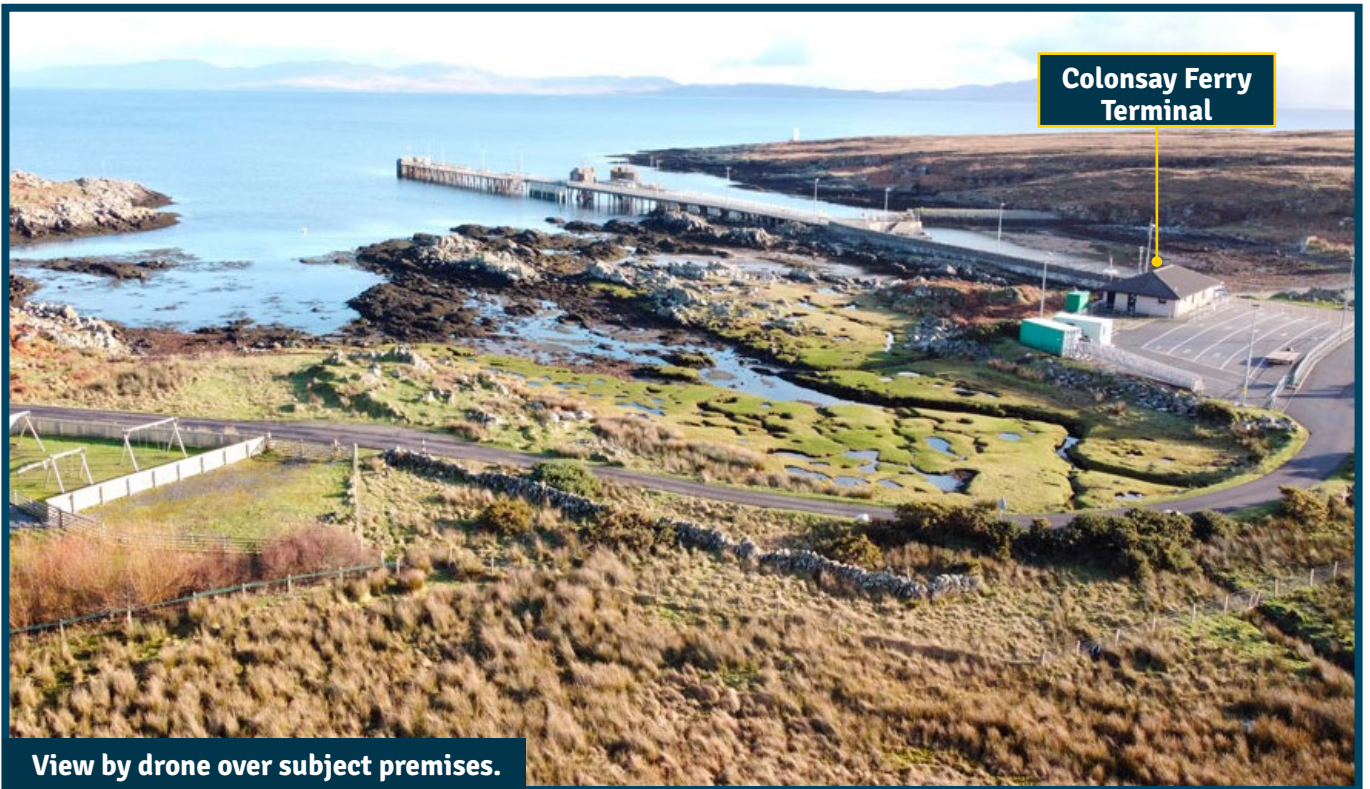
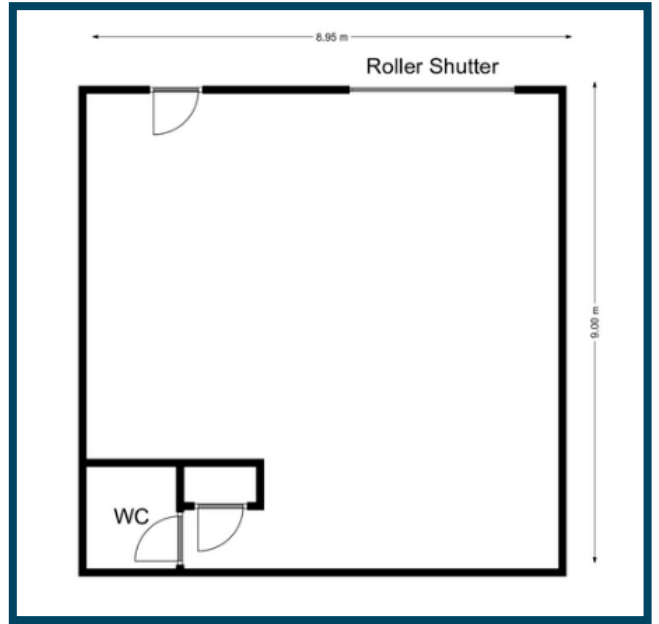
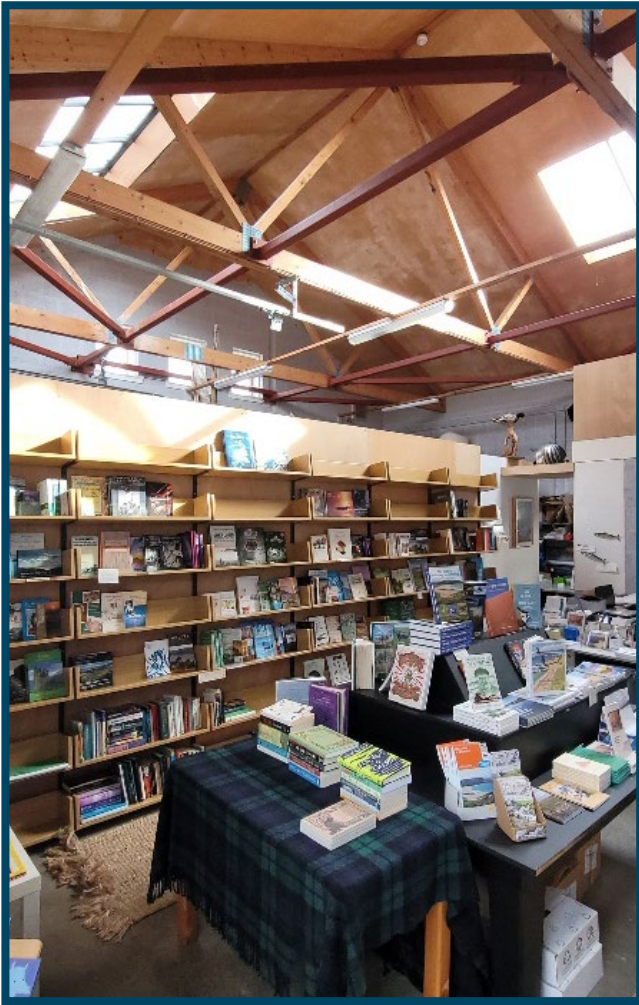

View by drone over subject premises.

IMPORTANT NOTE

DM Hall for themselves and for the vendors or lessors of this property, whose agents they are, give notice that:

- (i) The particulars are set out as a general outline only for the guidance of intended purchasers or lessees and do not constitute, nor constitute part of, an offer or contract.
- (ii) All descriptions, dimensions, reference to condition and necessary permissions for use and occupation, and other details are given without responsibility and any intended purchasers or tenants should not rely on them as statement or representation of fact but must satisfy themselves by inspection or otherwise as to the correctness of each of them
- (iii) No person in the employment of DM Hall has any authority to make or give any representation or warranty whatever in relation to the property.
- (iv) All prices, premiums and rents quoted are exclusive of VAT.
- (v) The information contained in these particulars has been checked and, unless otherwise stated, it is understood to be materially correct at the date of publication. After these details have been printed, circumstances may change outside our control.
- (vi) These particulars are provided for record purposes only and are not intended to create, nor to be relied upon as creating, any contractual relationship or commitment. Any contract shall only be entered into by way of our client's solicitors.